

FOR KEYNOTES REFER TO A/A07.02.
FOR GRAPHIC SCHEDULE REFER TO N/A00.03.
FOR WALLCOVERING GRAPHIC SPECIFIC
DIMENSIONS REFER TO J/A10.04.

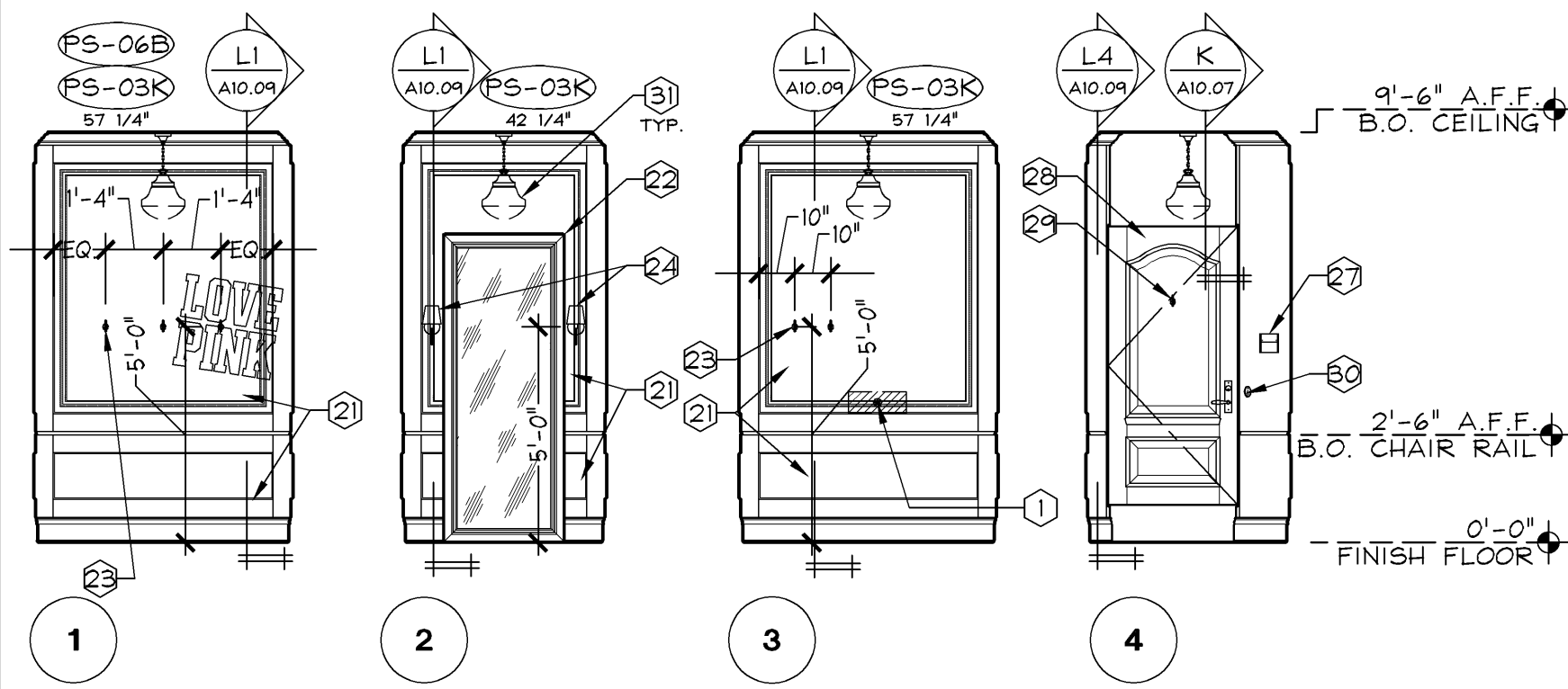

PINK STANDARD FITTING ROOM - FR 2
ELEVATIONS (TYPE A - PKGA)

1/4" = 1'-0"

S

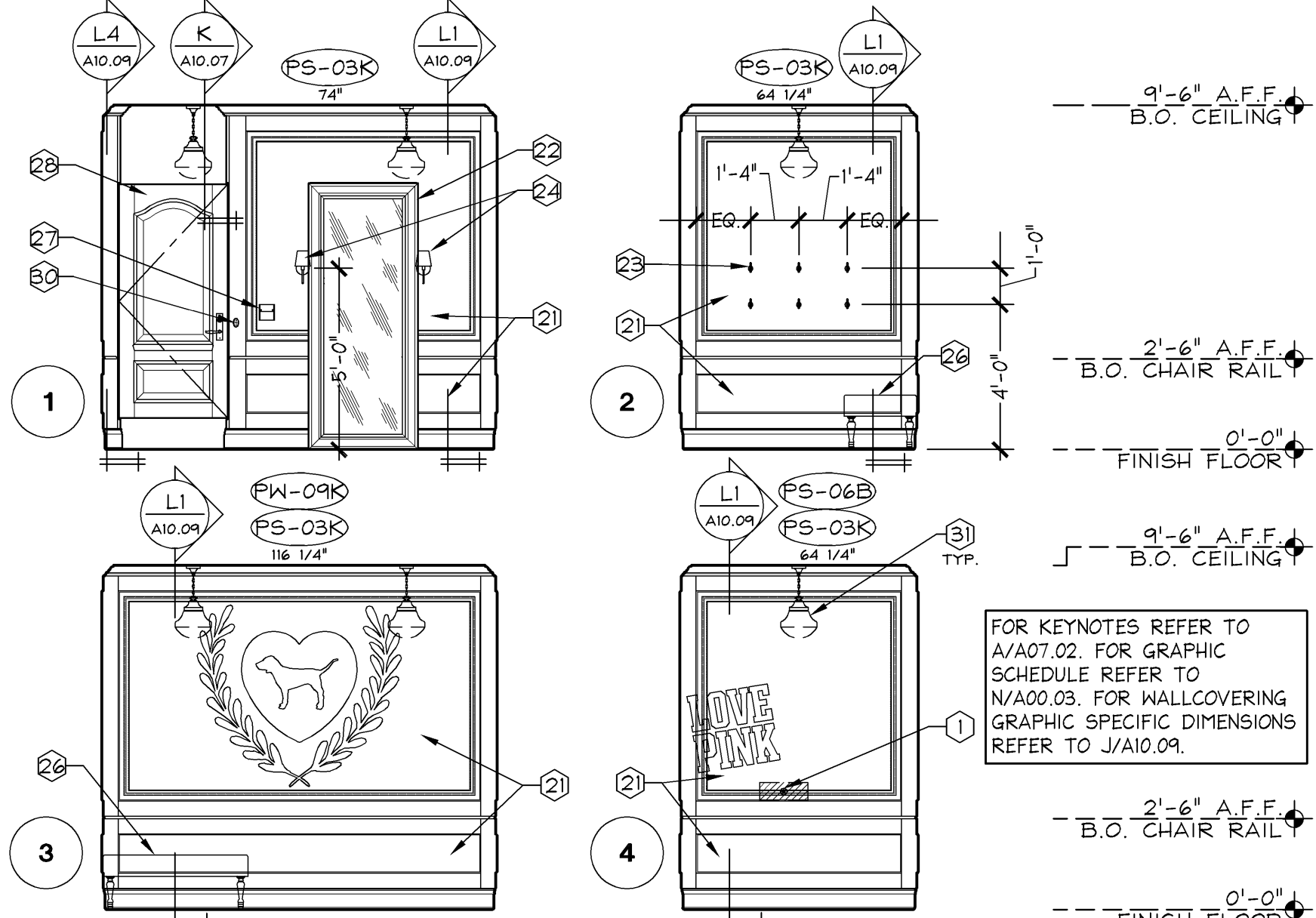

PINK ACCESSIBLE FITTING ROOM - AFR 1
ELEVATIONS (TYPE B - PKGA)

1/4" = 1'-0"

M

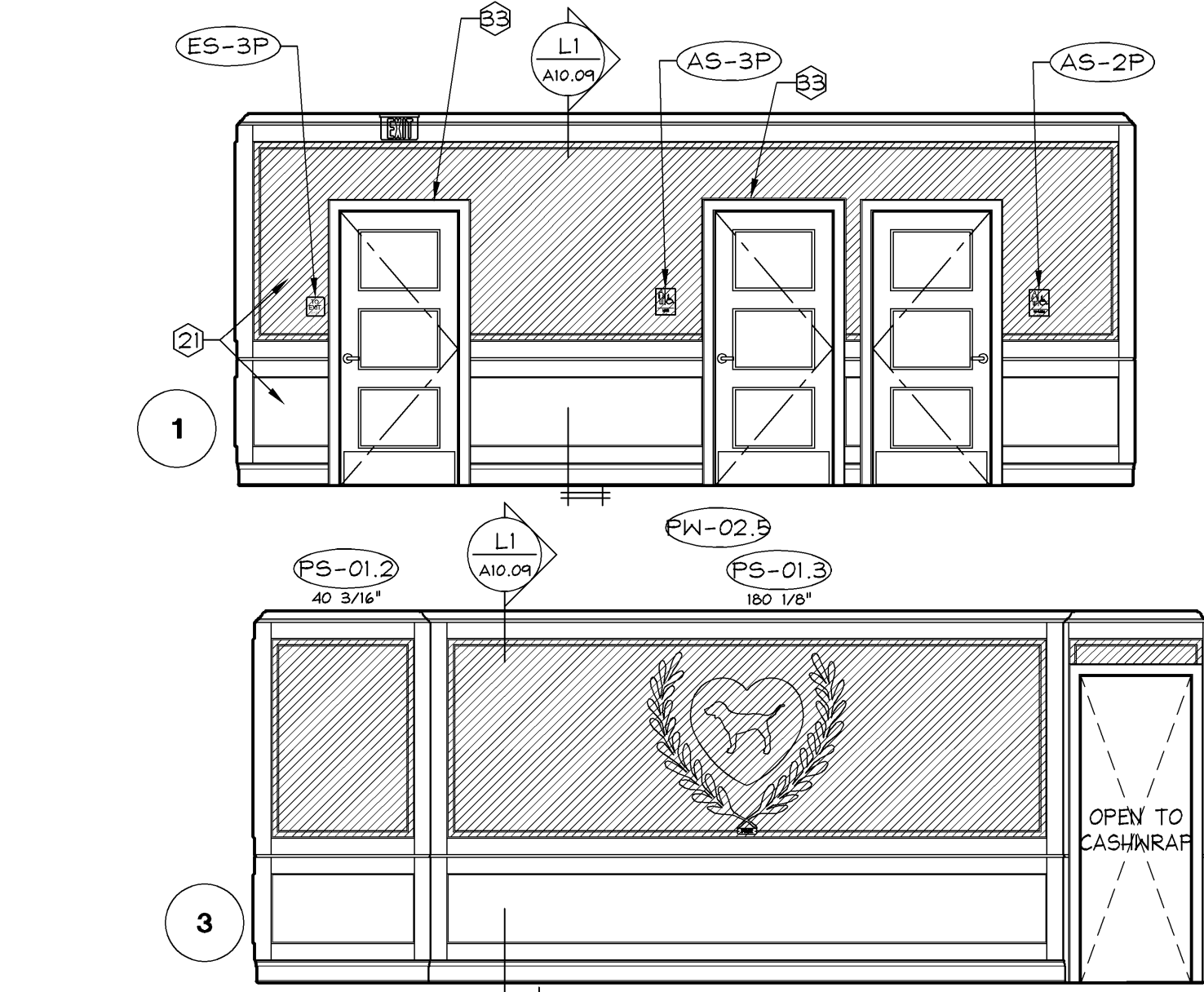

PINK VESTIBULE
ELEVATIONS

1/4" = 1'-0"

D

FOR KEYNOTES REFER TO A/A07.02.
FOR GRAPHIC SCHEDULE REFER TO N/A00.03.
FOR WALLCOVERING GRAPHIC SPECIFIC
DIMENSIONS REFER TO J/A10.04.

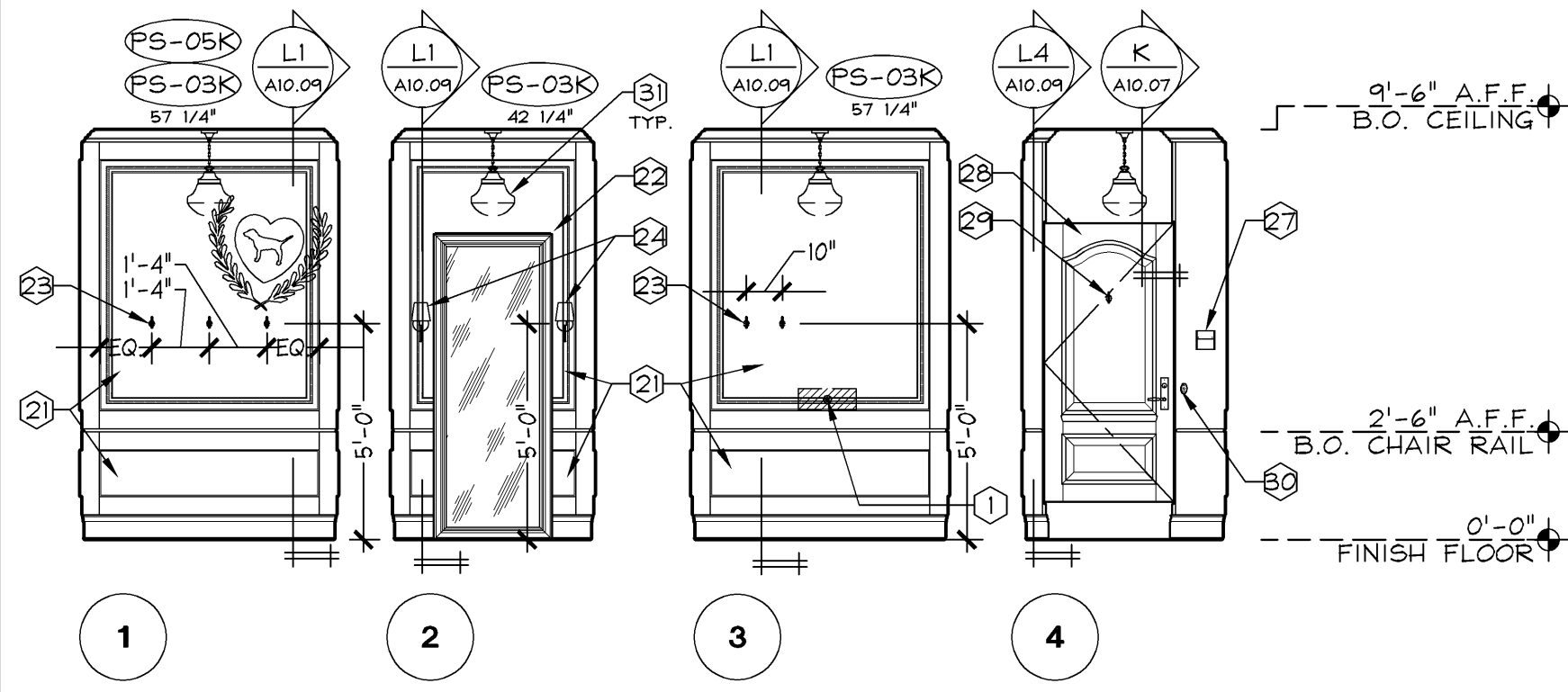

PINK STANDARD FITTING ROOM - FR 3
ELEVATIONS (TYPE A - PKGA)

1/4" = 1'-0"

R

FOR KEYNOTES REFER TO A/A07.02.
FOR GRAPHIC SCHEDULE REFER TO N/A00.03.
FOR WALLCOVERING GRAPHIC SPECIFIC
DIMENSIONS REFER TO J/A10.04.

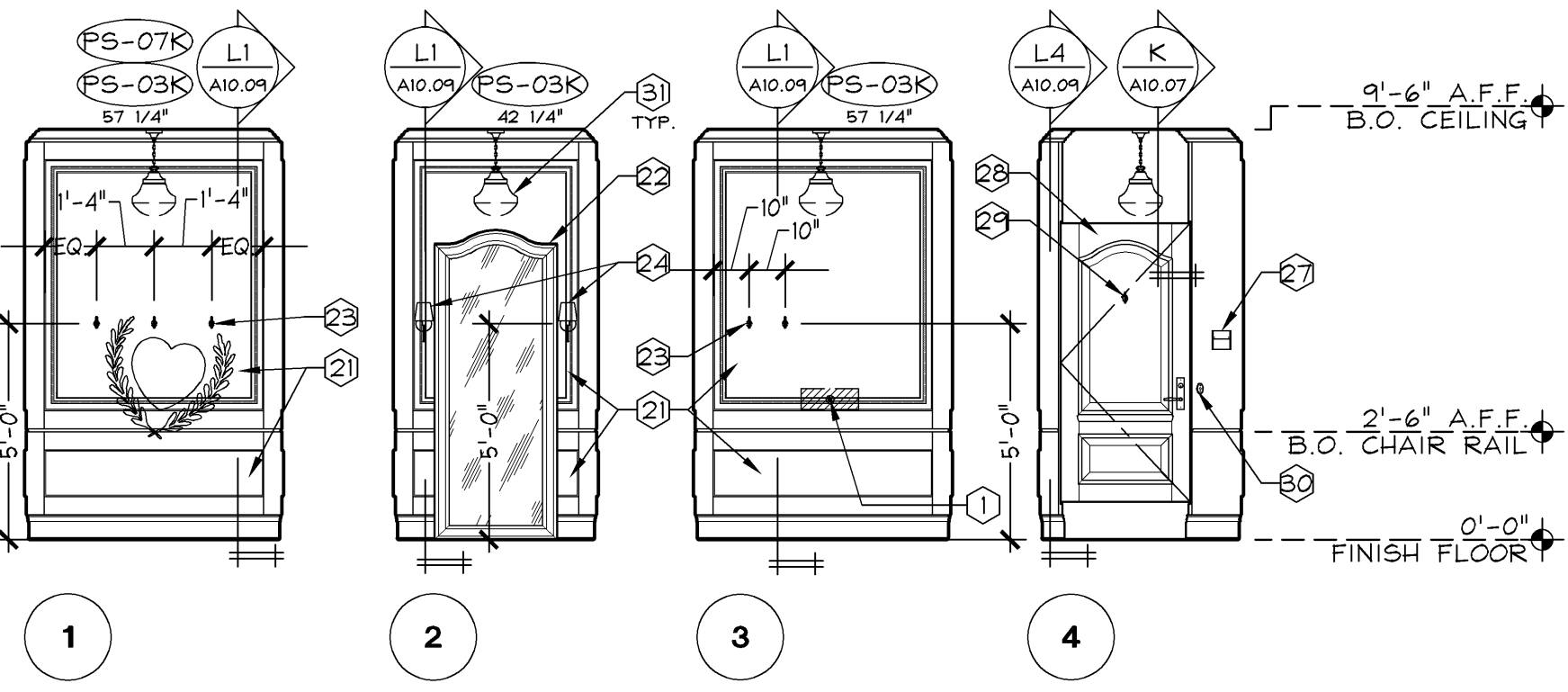

PINK STANDARD FITTING ROOM - FR 4
ELEVATIONS (TYPE A - PKGA)

1/4" = 1'-0"

L

FOR KEYNOTES REFER TO A/A07.02.
FOR GRAPHIC SCHEDULE REFER TO N/A00.03.
FOR WALLCOVERING GRAPHIC SPECIFIC
DIMENSIONS REFER TO J/A10.04.

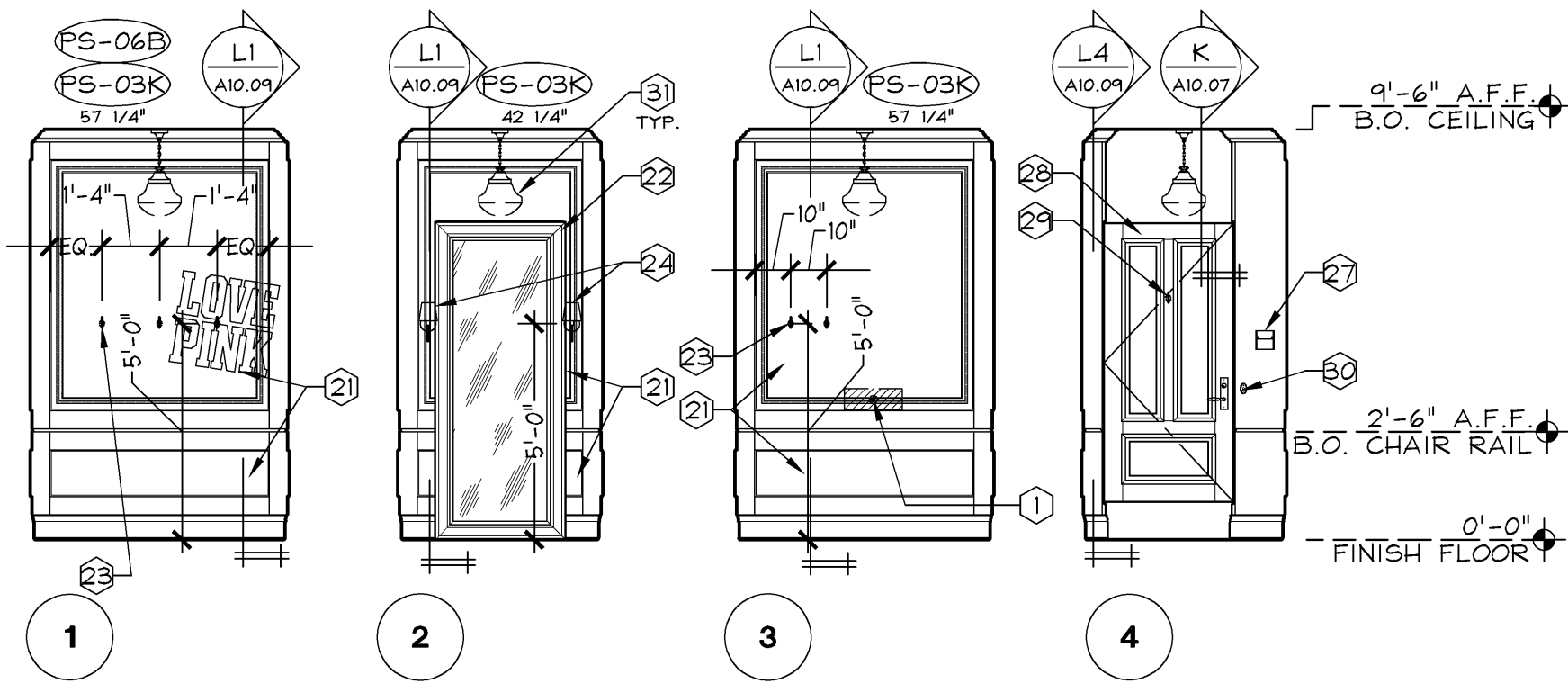

PINK STANDARD FITTING ROOM - FR 5
ELEVATIONS (TYPE A - PKGA)

1/4" = 1'-0"

G

FOR KEYNOTES REFER TO A/A07.02.
FOR GRAPHIC SCHEDULE REFER TO N/A00.03.
FOR WALLCOVERING GRAPHIC SPECIFIC
DIMENSIONS REFER TO J/A10.04.

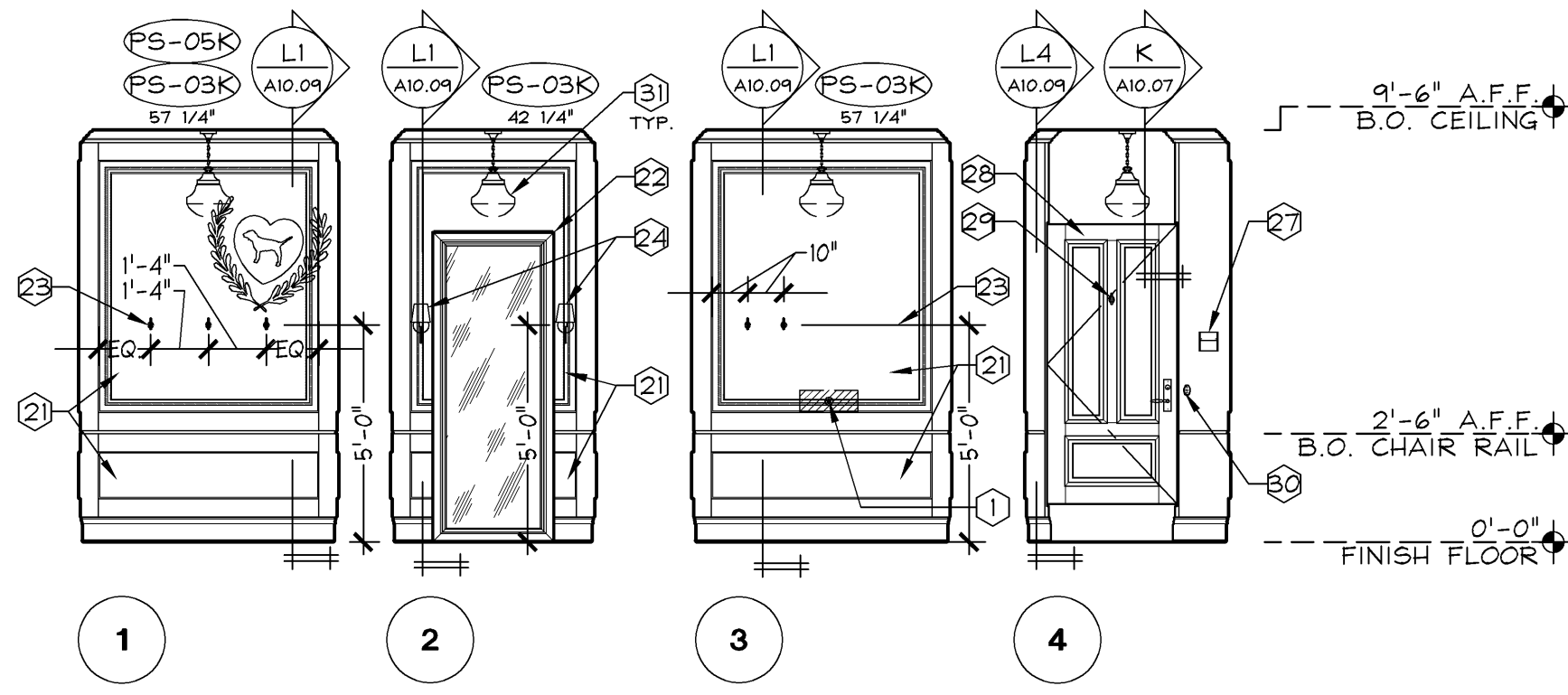

PINK STANDARD FITTING ROOM - FR 6
ELEVATIONS (TYPE A - PKGA)

1/4" = 1'-0"

C

FOR KEYNOTES REFER TO A/A07.02.
FOR GRAPHIC SCHEDULE REFER TO N/A00.03.
FOR WALLCOVERING GRAPHIC SPECIFIC
DIMENSIONS REFER TO J/A10.04.

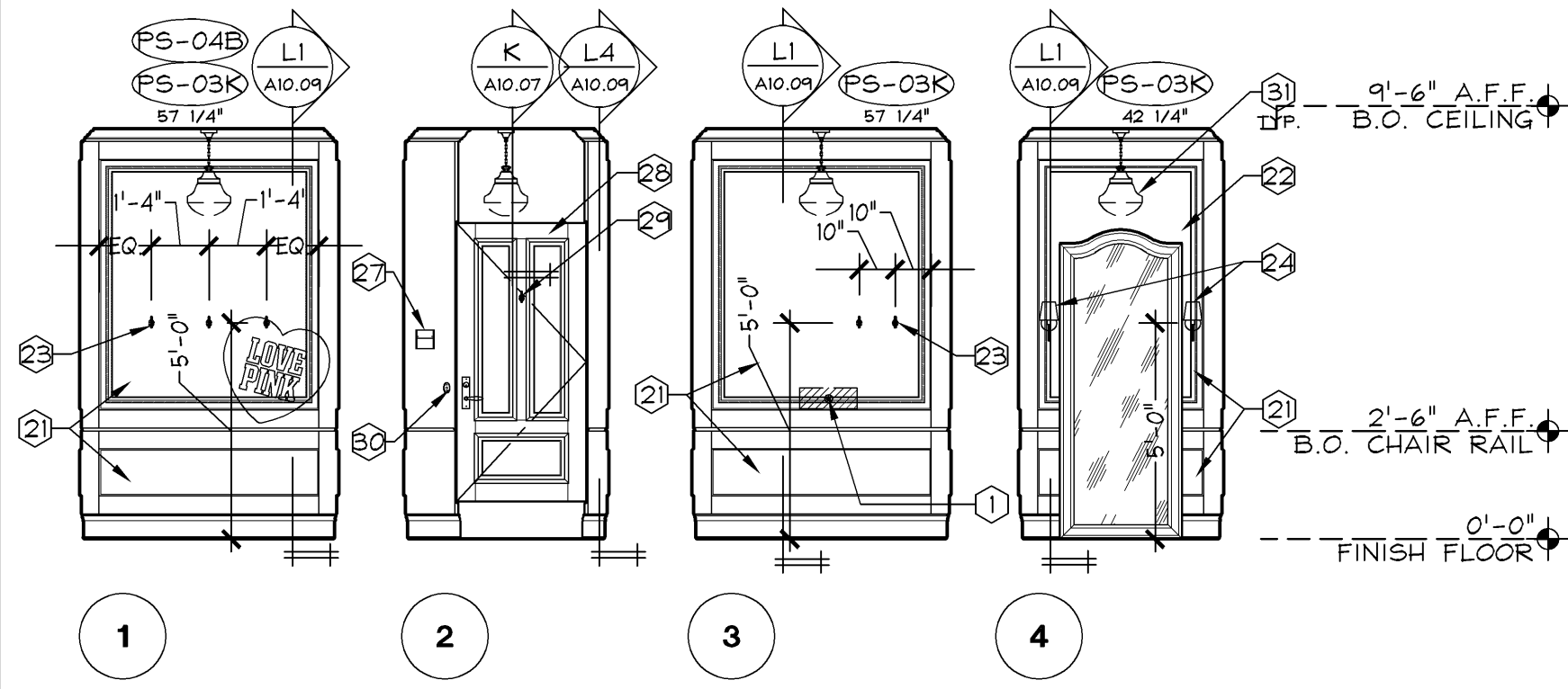

PINK STANDARD FITTING ROOM - FR 7
ELEVATIONS (TYPE A - PKGA)

1/4" = 1'-0"

P

FOR KEYNOTES REFER TO A/A07.02.
FOR GRAPHIC SCHEDULE REFER TO N/A00.03.
FOR WALLCOVERING GRAPHIC SPECIFIC
DIMENSIONS REFER TO J/A10.04.

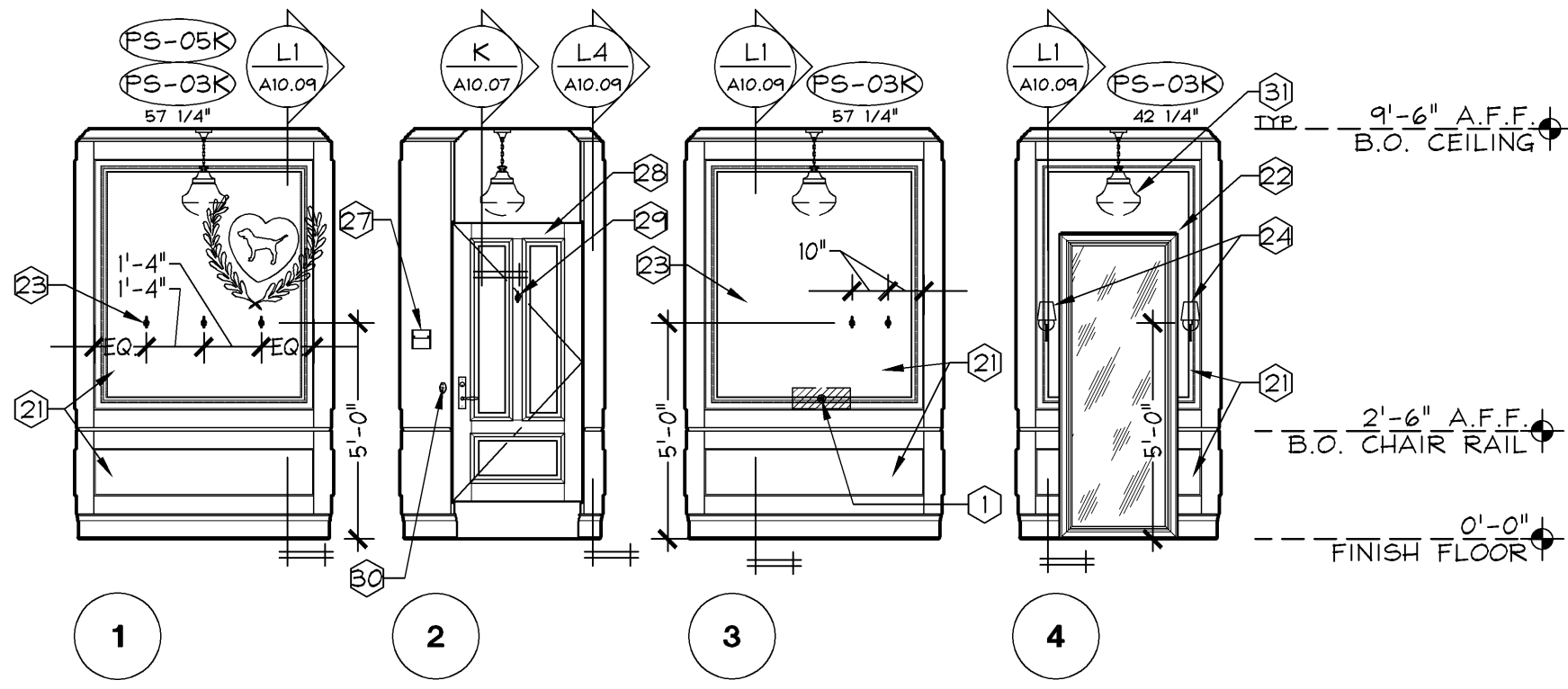

PINK STANDARD FITTING ROOM - FR 8
ELEVATIONS (TYPE A - PKGA)

1/4" = 1'-0"

K

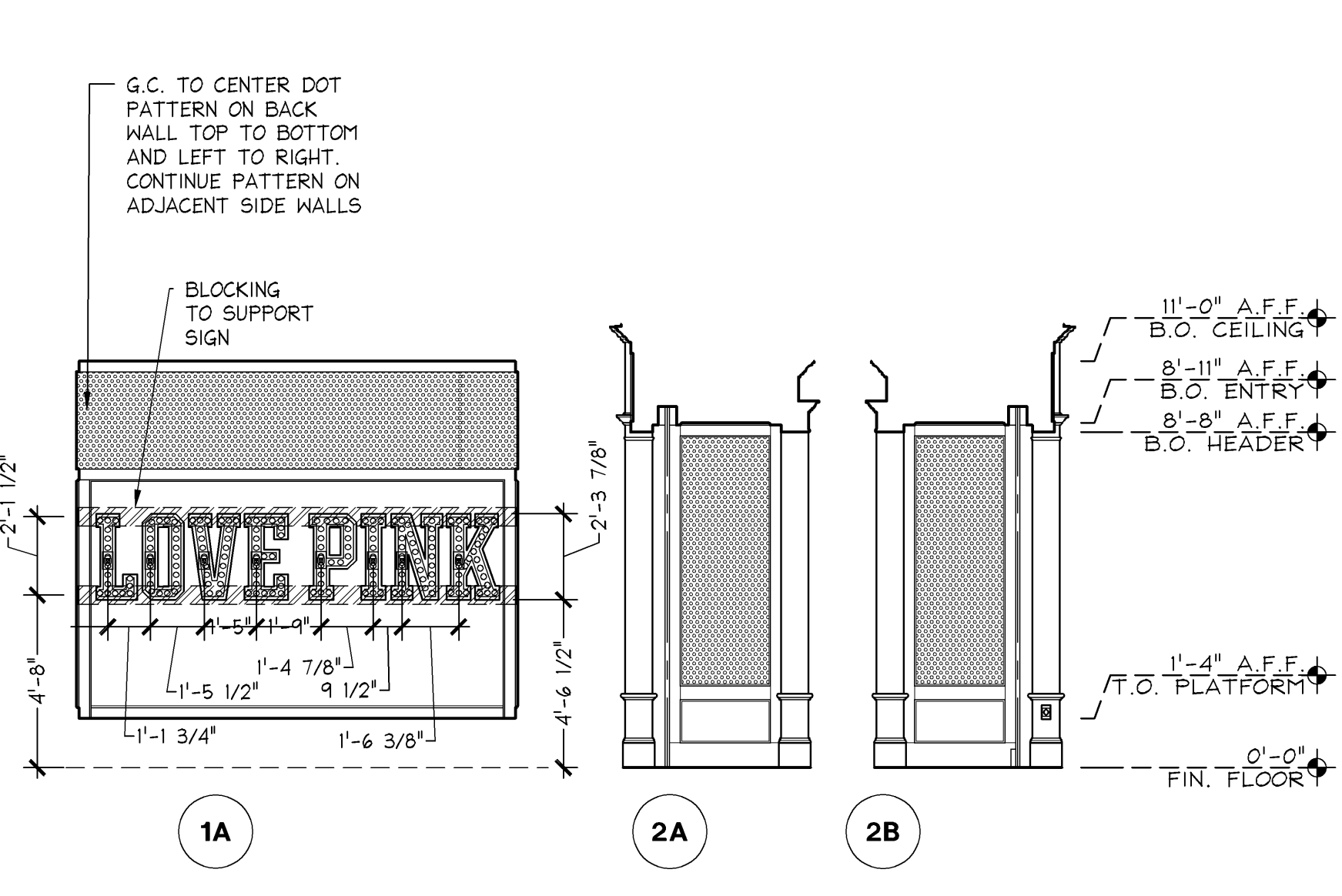

PINK STOREFRONT
ELEVATIONS

1/4" = 1'-0"

F

FOR KEYNOTES REFER TO A/A07.02.
FOR GRAPHIC SCHEDULE REFER TO N/A00.03.
FOR WALLCOVERING GRAPHIC SPECIFIC
DIMENSIONS REFER TO J/A10.04.

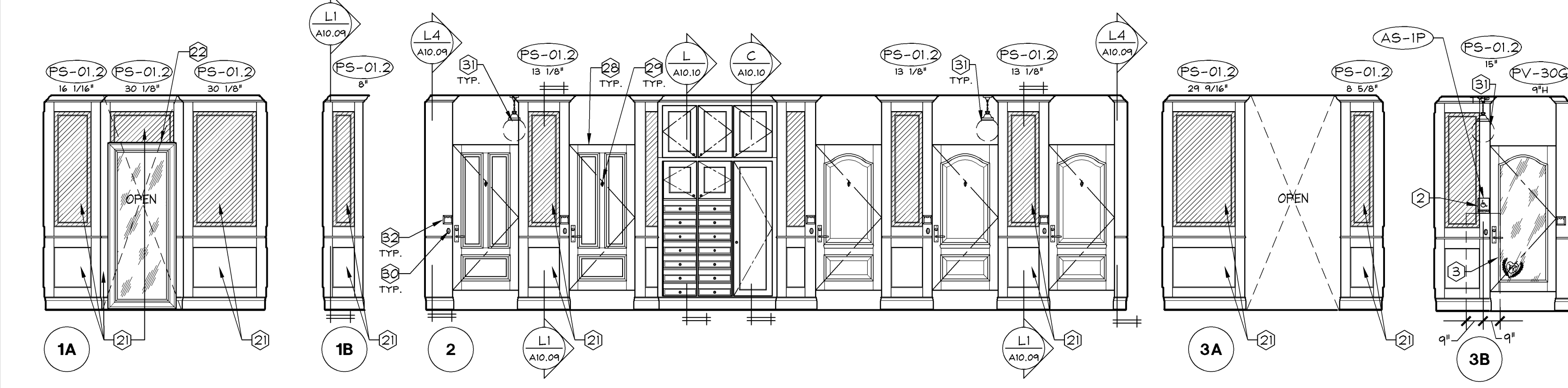

PINK FITTING ROOM ALCOVE
ELEVATIONS

1/4" = 1'-0"

E

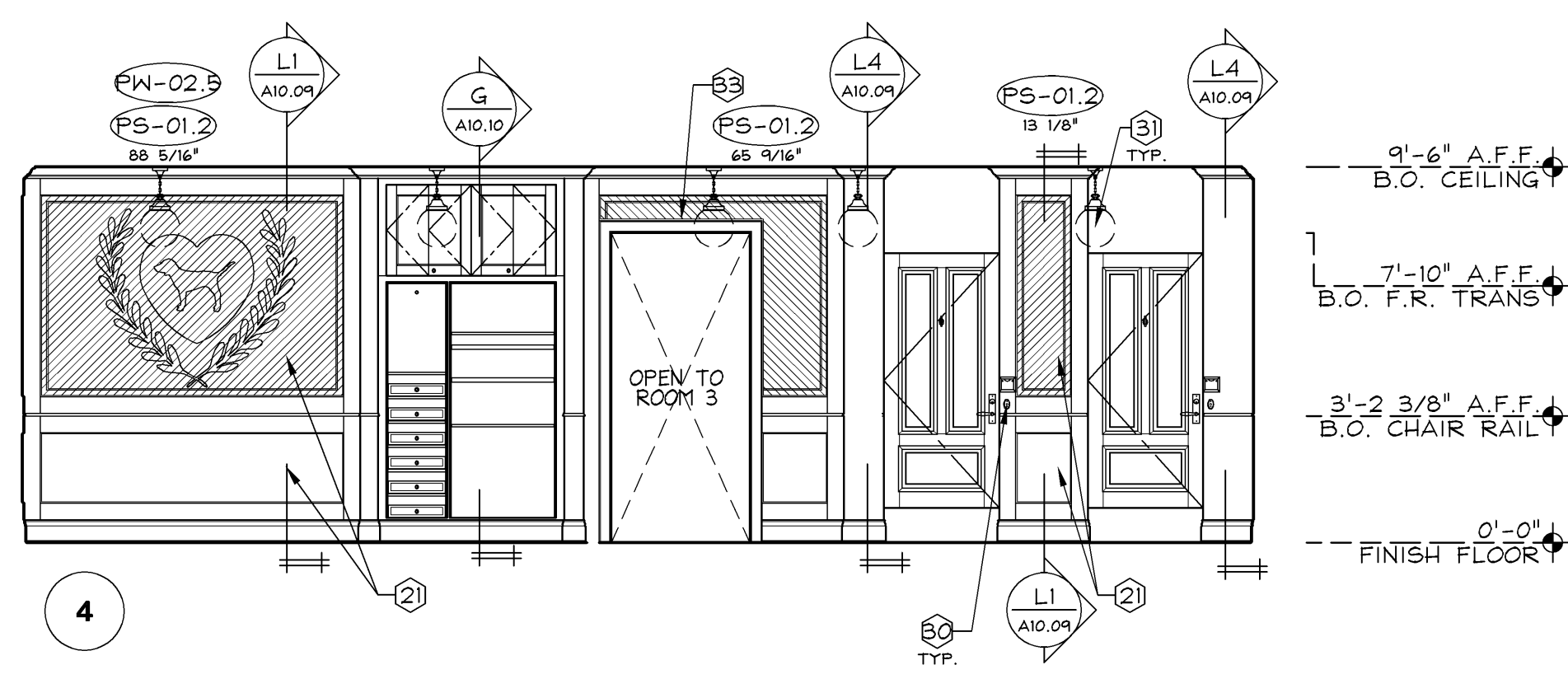

1/4" = 1'-0"

E

GENERAL

- WALL MOUNTED DOOR STOP MOUNTED TO ALIGN WITH DOOR LATCH, G.C. TO VERIFY EXACT LOCATION IN FIELD AND INSTALL METAL BLOCKING PER DETAIL E/A12.01
- ACCESSIBLE SIGNAGE. REFER TO DETAIL W/A00.04.
- 18" MIN. CLEAR FLOOR SPACE AT ACCESSIBLE SIGNAGE, CENTERED ON SIGNAGE.
- PINK
- WALLCOVERING GRAPHIC PANEL AT UPPER SECTION. G.C. TO PAINT LOWER SECTION P-29
- FITTING ROOM MIRROR. REFER TO B/A10.04 FOR DETAILS.
- FITTING ROOM HOOKS. REFER TO DETAIL K/A10.04 OR K/A11.08.
- FITTING ROOM WALL SCONCE LIGHT FIXTURE. SEE ELEVATIONS FOR MOUNTING HEIGHT. REFER TO ELEC DWGS FOR POWER REQUIREMENTS. SEE DETAIL P/A10.04.
- ACCESSIBLE FITTING ROOM BENCH. REFER TO G/A10.04
- PINK PAPER PANTY HOLDER. MOUNT TOP OF FIXTURE AT 4'-0" A.F.F. IN ACCESSIBLE ROOMS AND 4'-10" A.F.F. IN STANDARD ROOMS. INSTALL USING VENDOR SUPPLIED GYP. BD. ANCHORS AND SCREWS. OMIT THE ANCHORS WHEN INSTALLED AT WOOD TRIM.
- PRE-FINISHED FITTING ROOM DOOR. REFER TO DOOR SCHEDULE ON SHEET A00.02.
- HOOK MOUNTED ON BOTH SIDES OF DOOR @ 5'-7" A.F.F. REFER TO DETAIL K/A10.04. NOTE: HOOK NOT TO BE INSTALLED ON HANDICAP ACCESSIBLE DOOR.
- PAGING SYSTEM BUTTON - REFER TO ELECTRICAL DRAWINGS FOR SPECS AND POWER/ DATA REQUIREMENTS. MOUNT @ AT 3'-6" A.F.F. AND 2 1/2" FROM EDGE OF JAMB. SEE DETAIL J/A10.07 FOR PLACEMENT. SEE DETAIL M/A12.02 FOR BLOCKING REQUIREMENTS.
- PENDANT LIGHT FIXTURE W/ BOTTOM AT 7'-6" A.F.F. REFER TO ELEC DWGS.
- FIT CARD HOLDER. @ MOUNTED AT 4'-0" A.F.F. AND EDGE OF HOLDER TIGHT TO DOOR TRIM USING VENDOR SUPPLIED GYP. BD. ANCHORS AND SCREWS. OMIT THE ANCHORS WHEN INSTALLED AT WOOD TRIM
- G.C. TO SCRIBE WALLCOVERING TO DOOR/TRANSITION CASING THEN APPLY QUARTER ROUND TRIM

ELEVATION NOTES

1/4" = 1'-0"

A

GreenbergFarrow
1430 West Peachtree Street NW
Suite 200
Atlanta, GA 30309
t. 404 601 4000 f. 404 601 3970

Limited brands

LIMITED STORE PLANNING, INC.
d/b/a STORE DESIGN & CONSTRUCTION
Three Limited Parkway • Columbus, Ohio 43230
Telephone: 614.415.7000 • Fax: 614.415.7349

010501726

PINK VICTORIA'S SECRET

3401 NICHOLASVILLE RD
LEXINGTON, KY 40503

PROJECT INFORMATION:

REVISIONS:

ELITE CONSTRUCTION GROUP
LAKE JACKSON, TX
PHONE: 979-284-0712
NOTE: THESE PRINTS HAVE BEEN
REDUCED BY 50 PERCENT SCALE
WILL BE 50 PERCENT OF WHAT IS
NOTED ON PLANS

DATE ISSUED: 09-05-2014
DESIGNED BY: APL
DRAWN BY: AS
CHECKED BY: AJD

INTERIOR
ELEVATIONS

DRAWING NUMBER:

A07.02